

APPENDIX 2

Notes:

- o Build out to be extended in one direction only
- o 2no. parking spaces to be removed
- o Bus stop marking to be placed on Harbour side of road

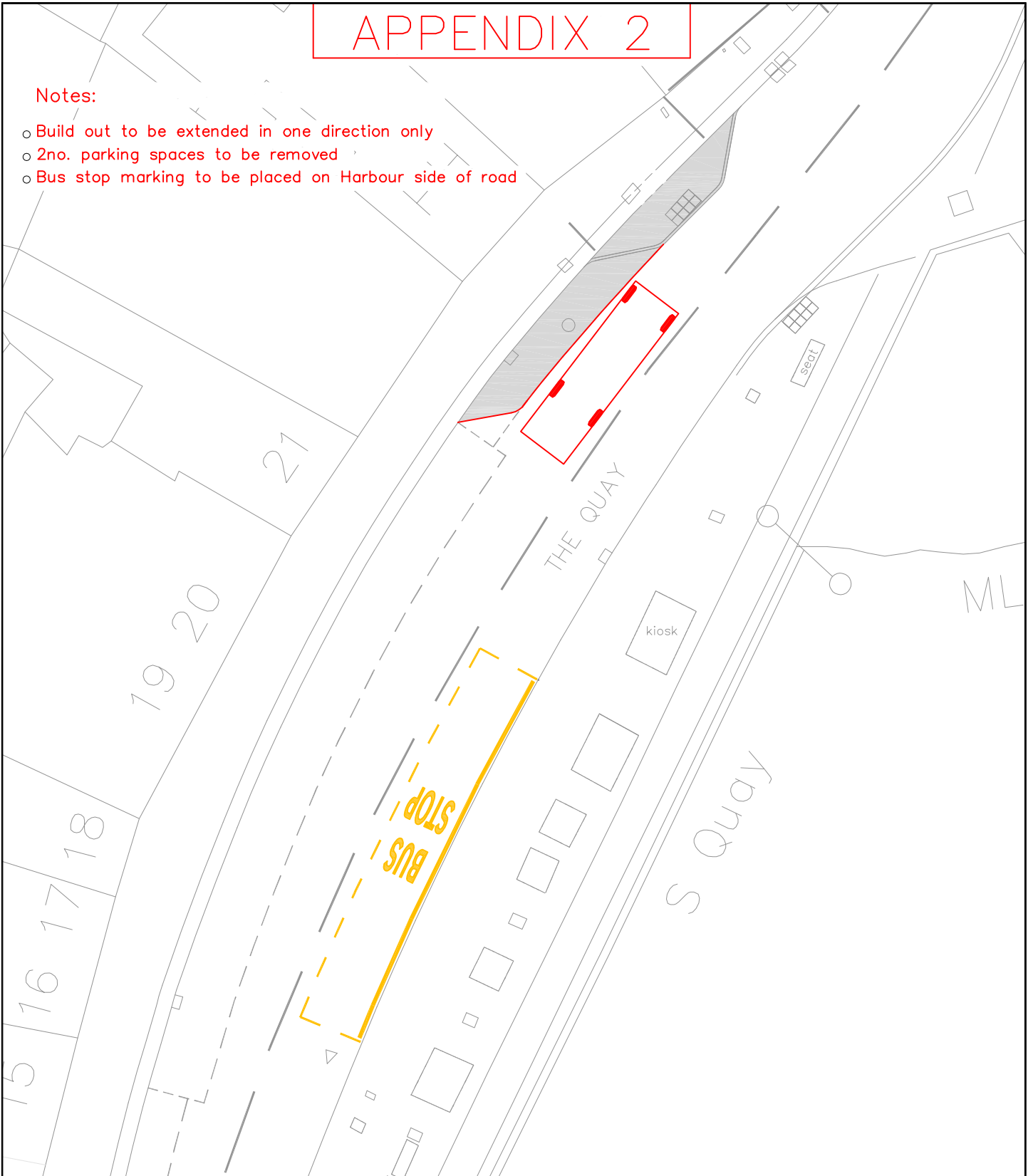

SUE CHERITON
EXECUTIVE HEAD,
RESIDENTS & VISITOR SERVICES,
LOWER GROUND FLOOR,
TOWN HALL,
TORQUAY.
TQ1 3DR

NOTES

no.	details

REVISIONS

no.	date	details

SCHEME TITLE
Proposed Torquay-Brixham Fast Ferry Service

drawn
LS

scale(s)
1:250

DRAWING TITLE
Proposed Bus Bay Layout Brixham Quay (Option 2)

checked
PW

date
09/04/2014

drawing number	*/*/** **	rev.	-
----------------	-----------	------	---